

ARCADIA LOGISTICS CENTER,
CITY OF ARCADIA, CALIFORNIA

CELINE ST. VIEW, looking East towards Building 2. The view was taken at approximately 2 PM, using a 35 mm lens, approximately 800 feet from Building 2. The maximum visible building height is 42 feet with a foreground buffer of proposed and existing trees.

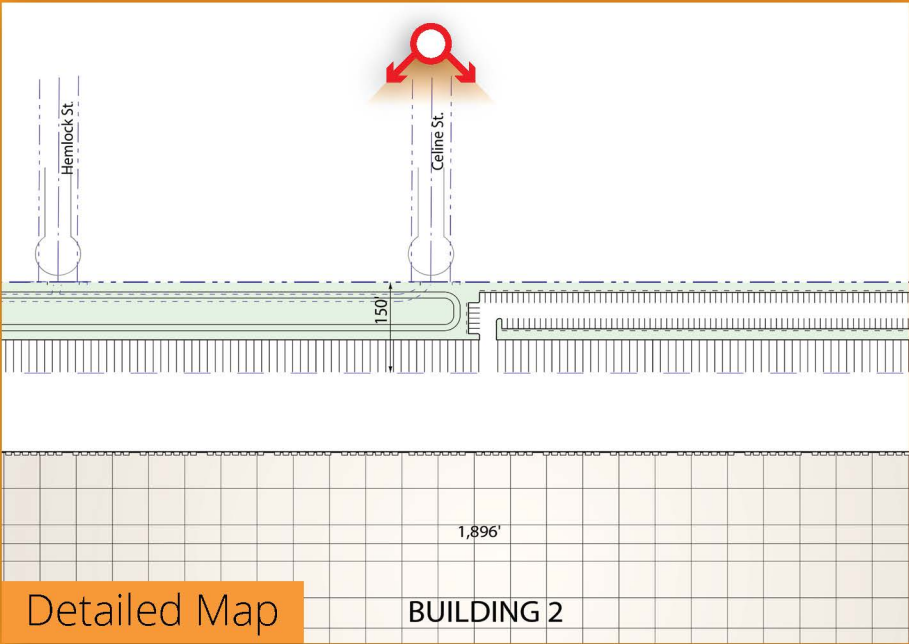
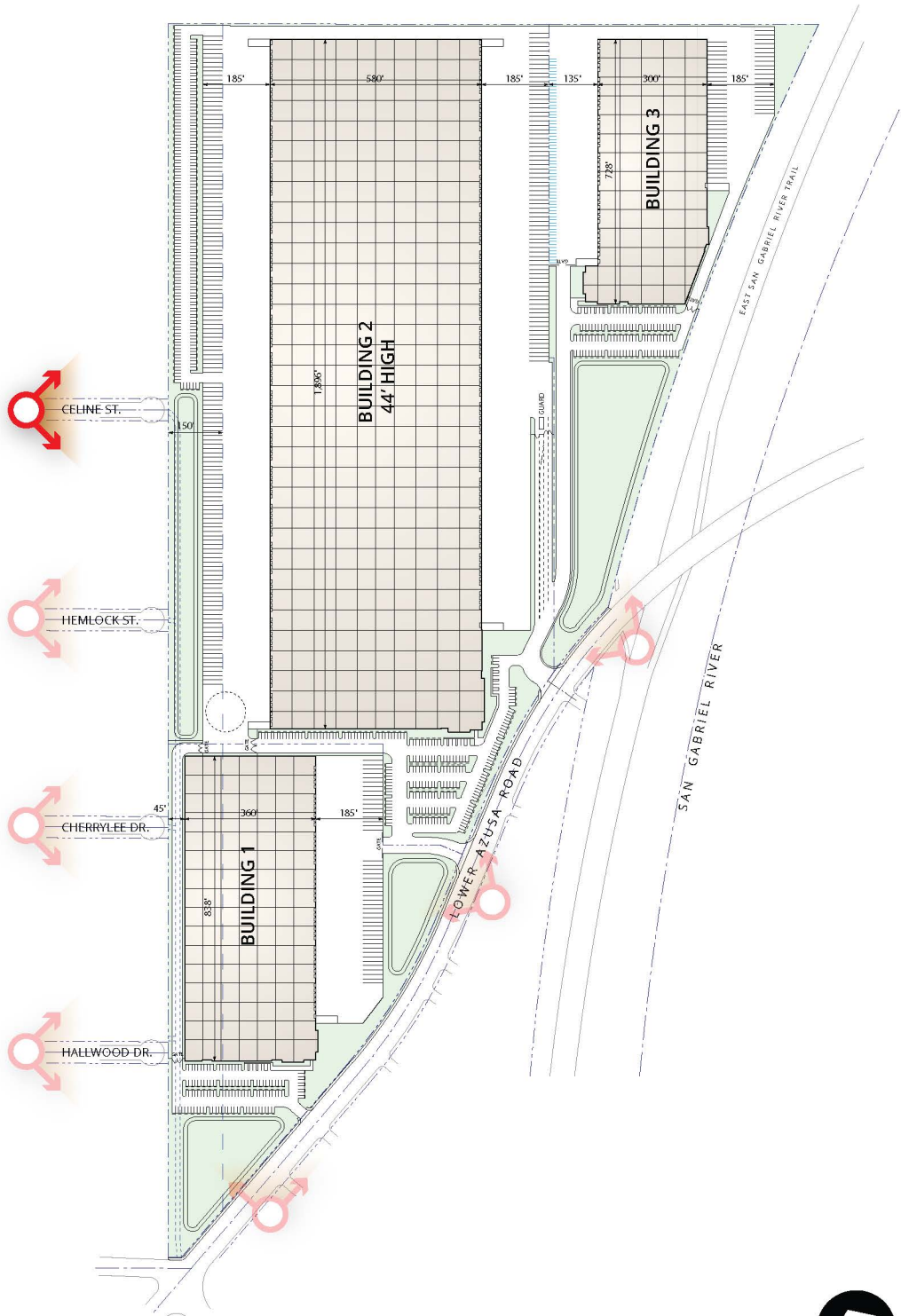

Detailed Map

BUILDING 2



Existing View



Proposed View

ARCADIA LOGISTICS CENTER,
CITY OF ARCADIA, CALIFORNIA

HEMLOCK ST. VIEW, looking East towards Building 2. The view was taken at approximately 2:30 PM, using a 33 mm lens, approximately 650 feet from Building 2. The maximum visible building height is 42 feet with a foreground buffer of proposed and existing trees.

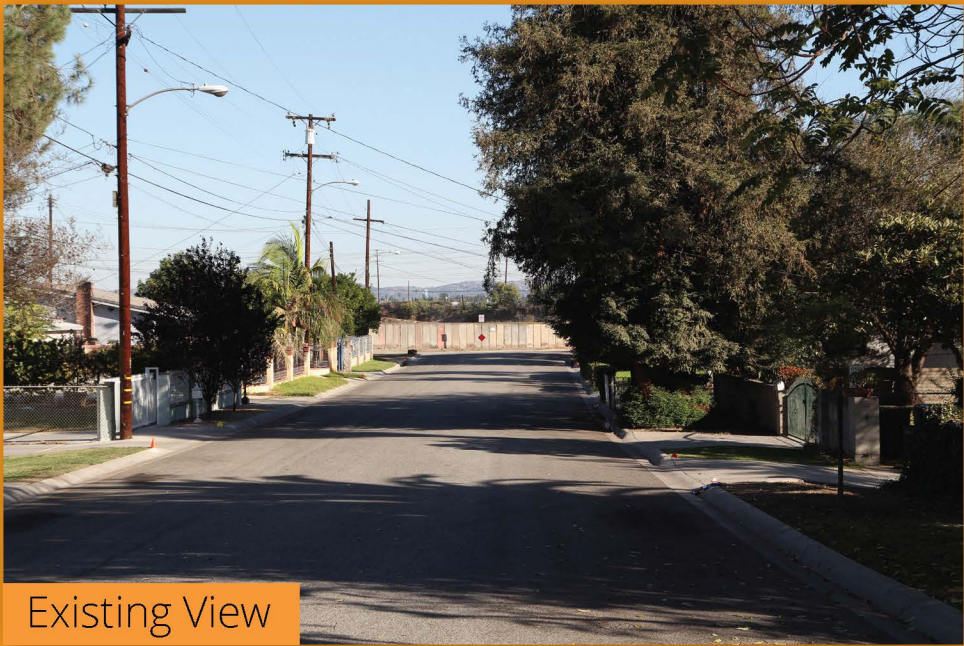
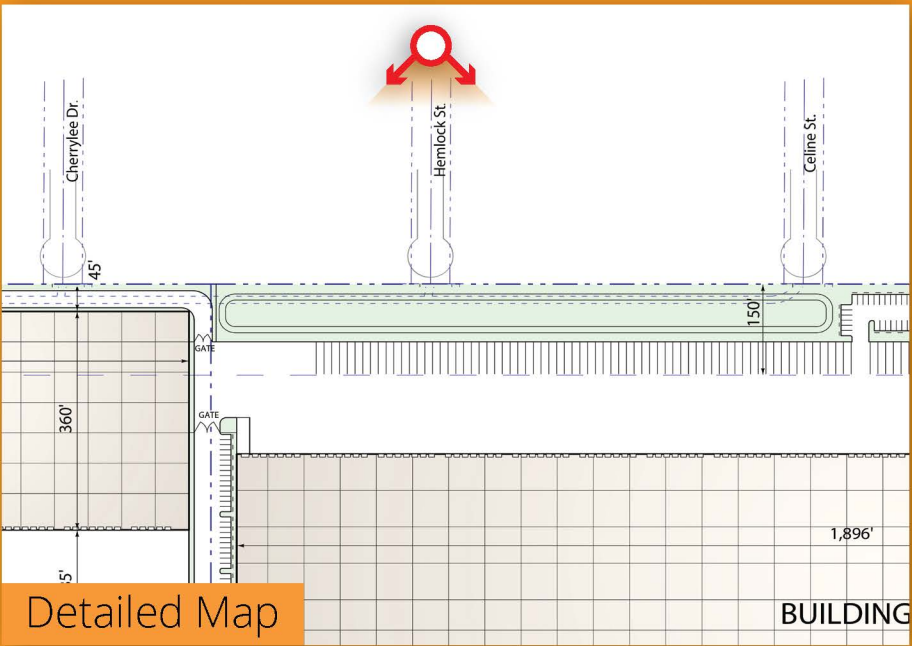
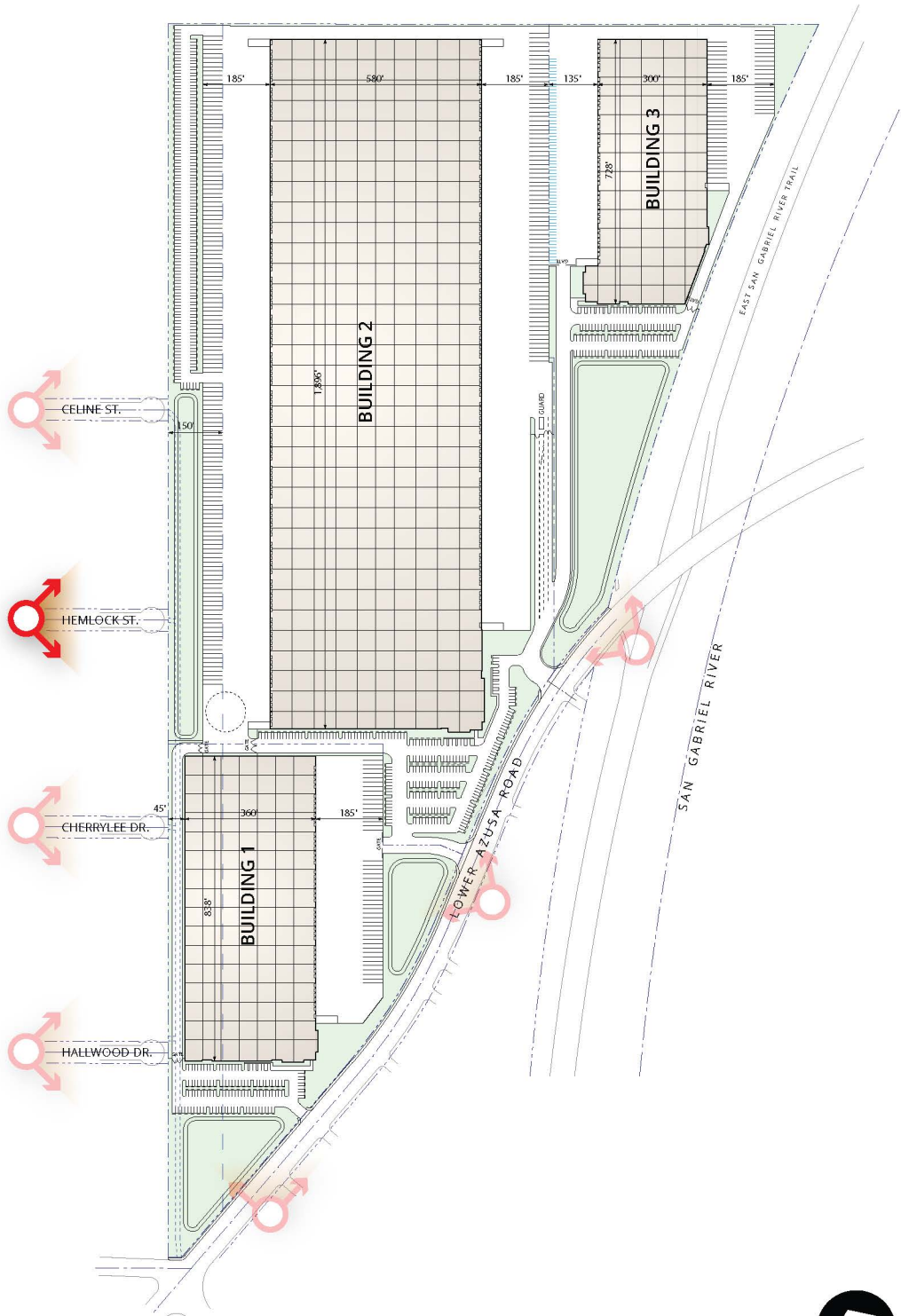

ARCADIA LOGISTICS CENTER,
CITY OF ARCADIA, CALIFORNIA

CHERRYLEE DR. VIEW, looking East towards Building 1. The view was taken at approximately 4:30 PM, using a 35 mm lens, approximately 450 feet from Building 1. The maximum visible building height is 40 feet with a foreground buffer of proposed and existing trees.

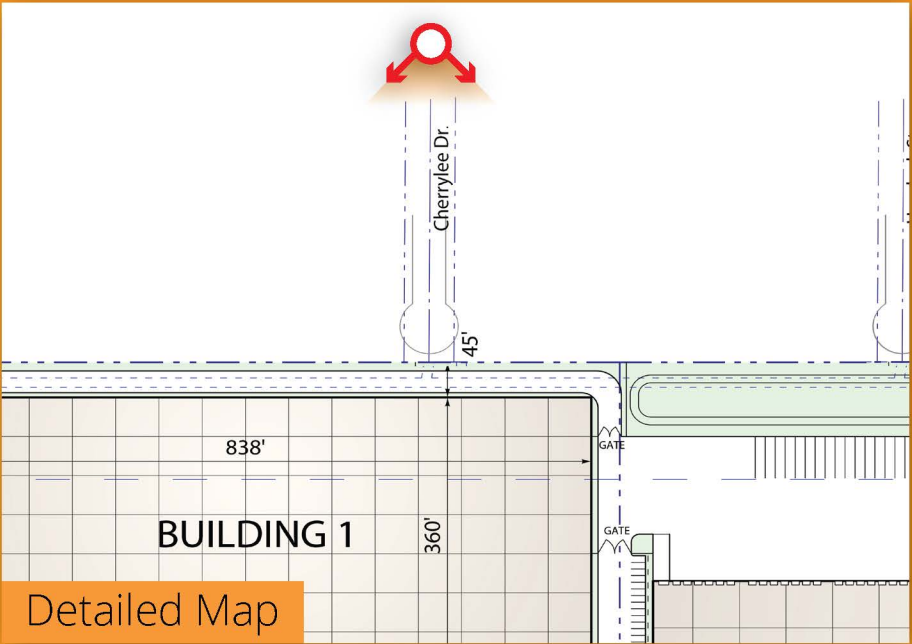
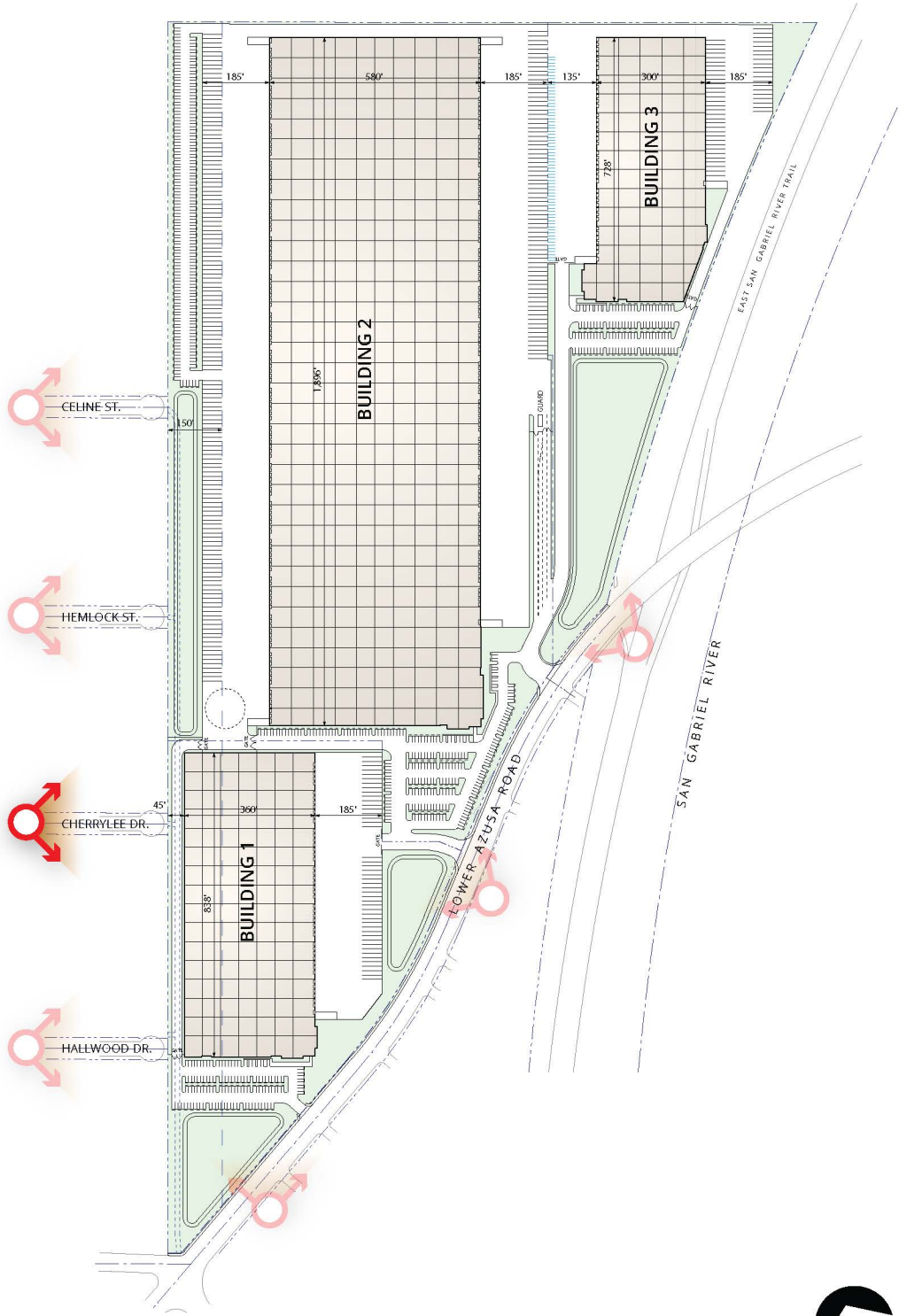

Detailed Map

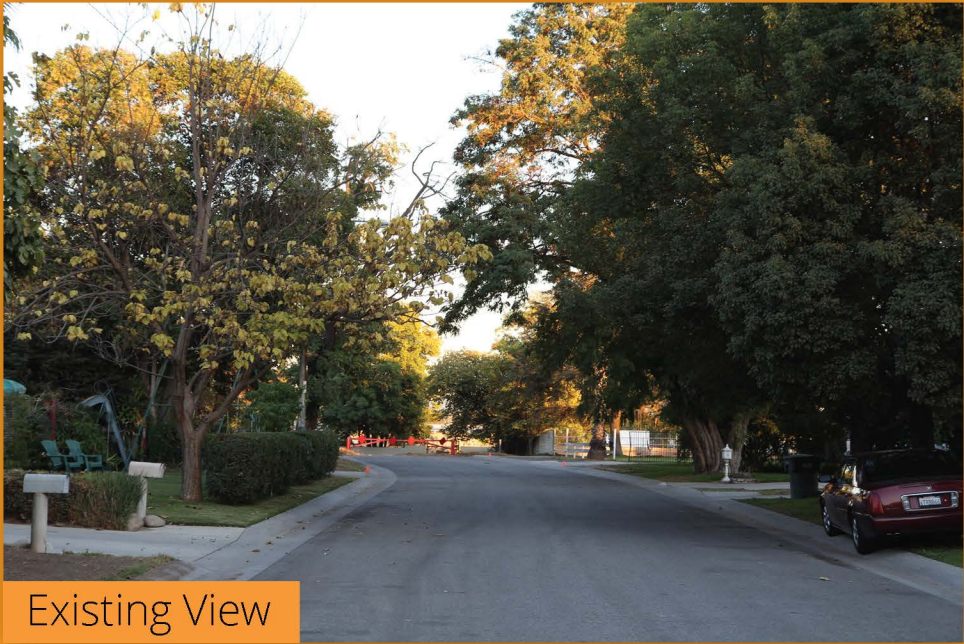

Existing View

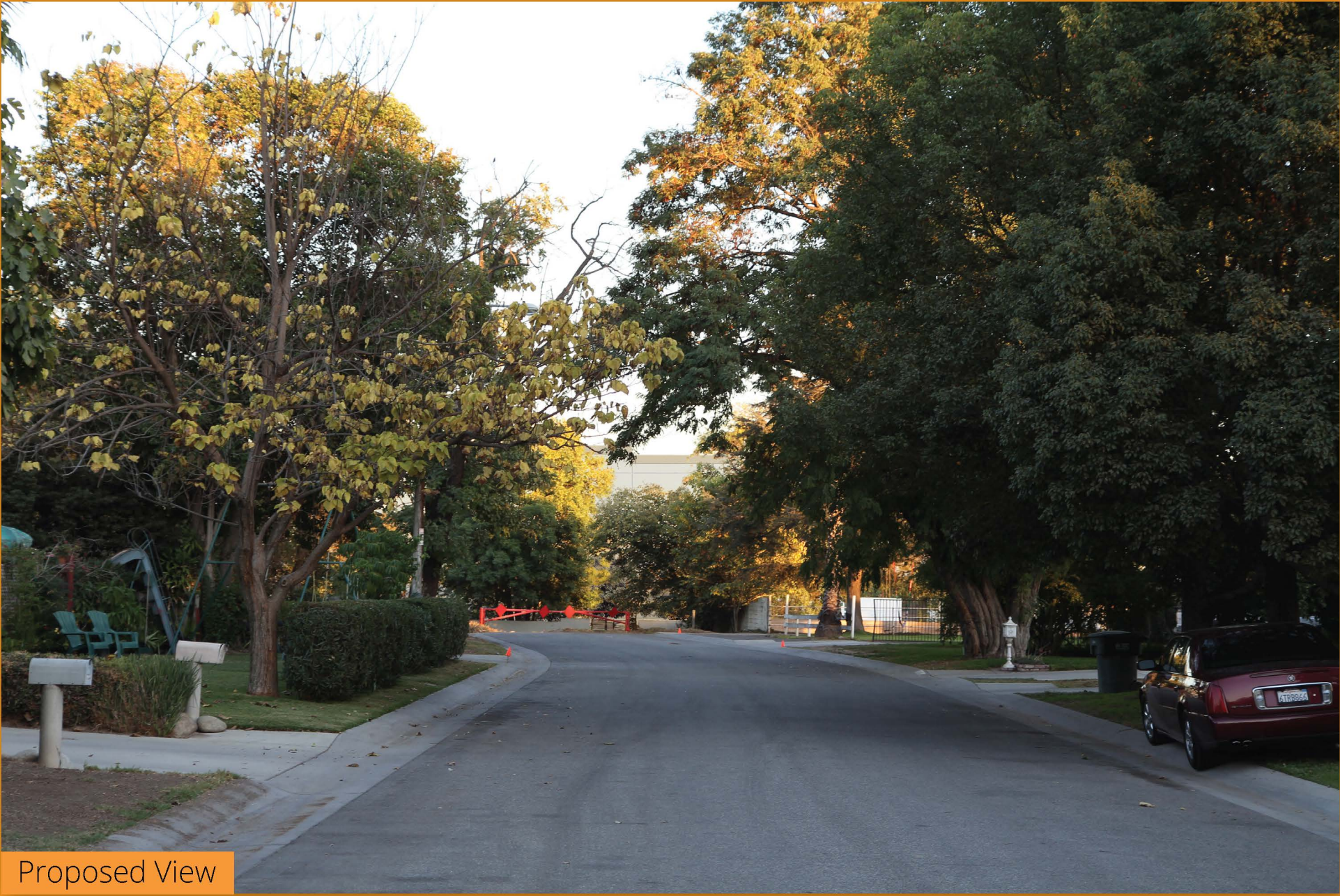

Proposed View

ARCADIA LOGISTICS CENTER,
CITY OF ARCADIA, CALIFORNIA

HALLWOOD DR. VIEW, looking East towards Building 1. The view was taken at approximately 4 PM, using a 33 mm lens, approximately 500 feet from Building 1. The maximum visible building height is 44 feet with a foreground buffer of proposed and existing trees.

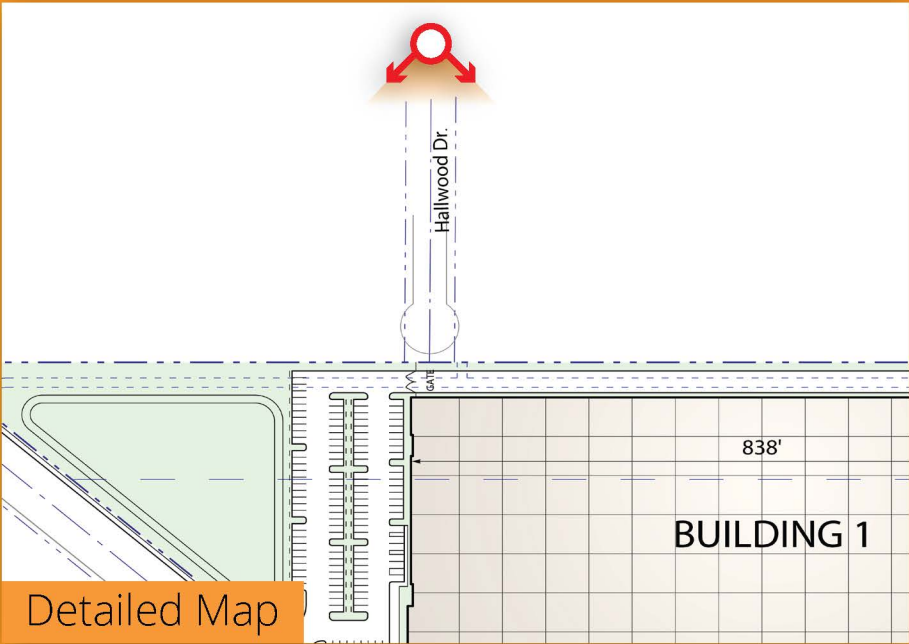
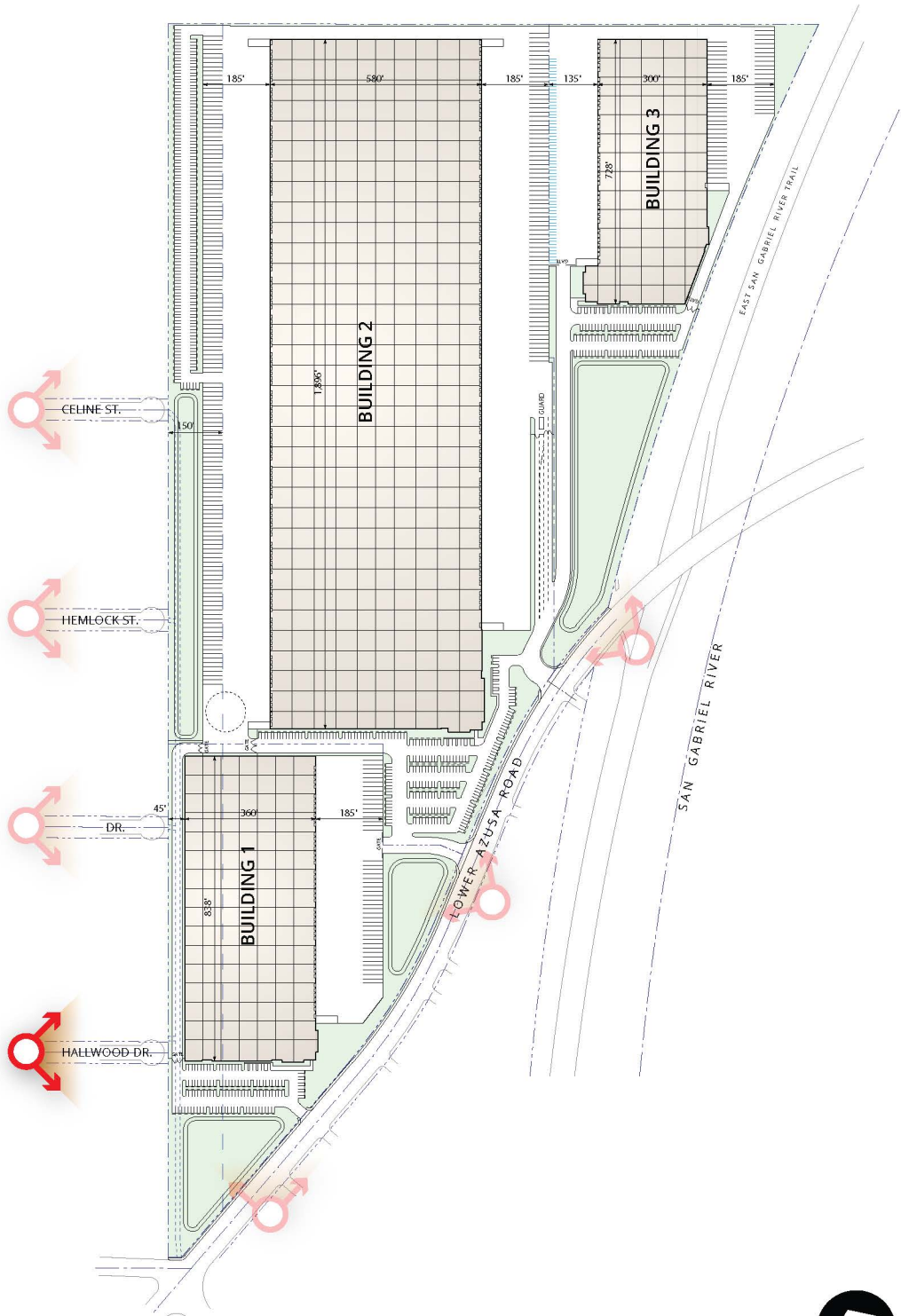

Detailed Map



Existing View



Proposed View

ARCADIA LOGISTICS CENTER,
CITY OF ARCADIA, CALIFORNIA

LOWER AZUSA ROAD. VIEW 1, looking North towards Building 1. The view was taken at approximately 3 PM, using a 35 mm lens, approximately 450 feet from Building 1. The maximum visible building height is 50 feet with a foreground buffer of proposed and existing trees.

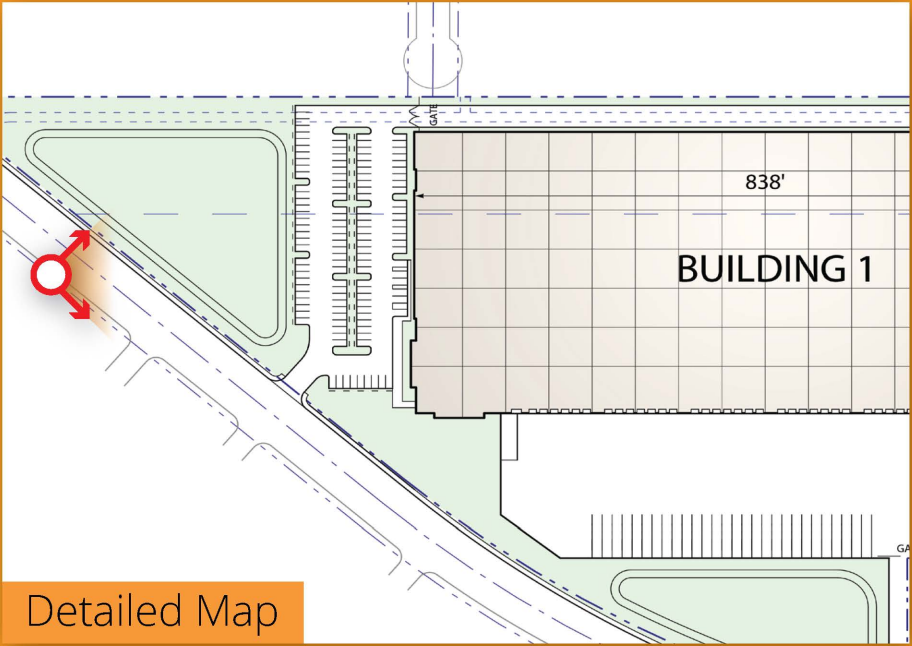
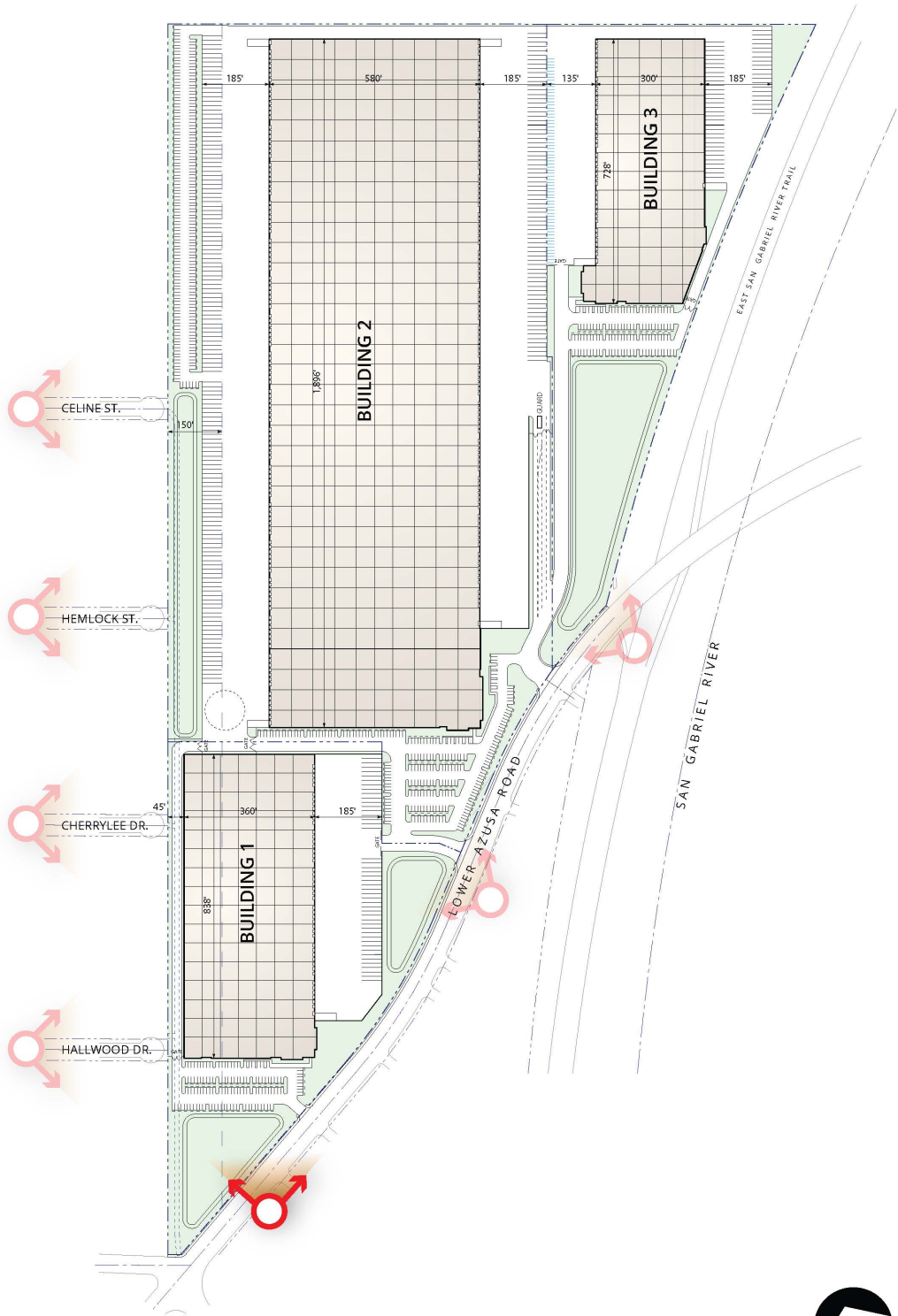

Detailed Map



Existing View



Proposed View

ARCADIA LOGISTICS CENTER,
CITY OF ARCADIA, CALIFORNIA

LOWER AZUSA ROAD. VIEW 2, looking North West towards Buildings 1 and 2. The view was taken at approximately 2 PM, using a 17 mm lens, approximately 450 feet from the entrance of building 2. The maximum visible building height is 40 feet for Building 1 and 52 feet for Building 2 with a foreground buffer of proposed and existing trees.

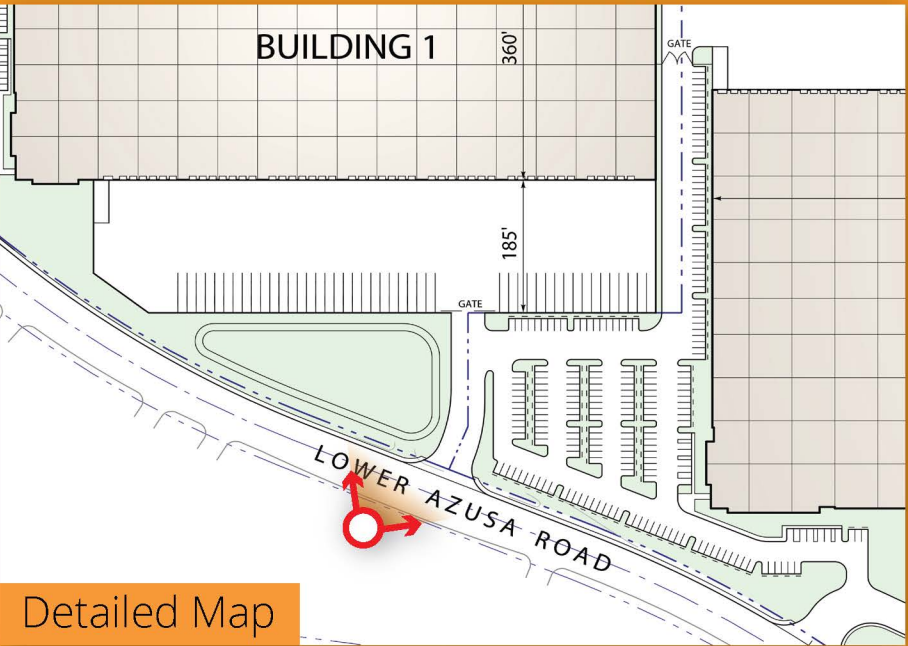
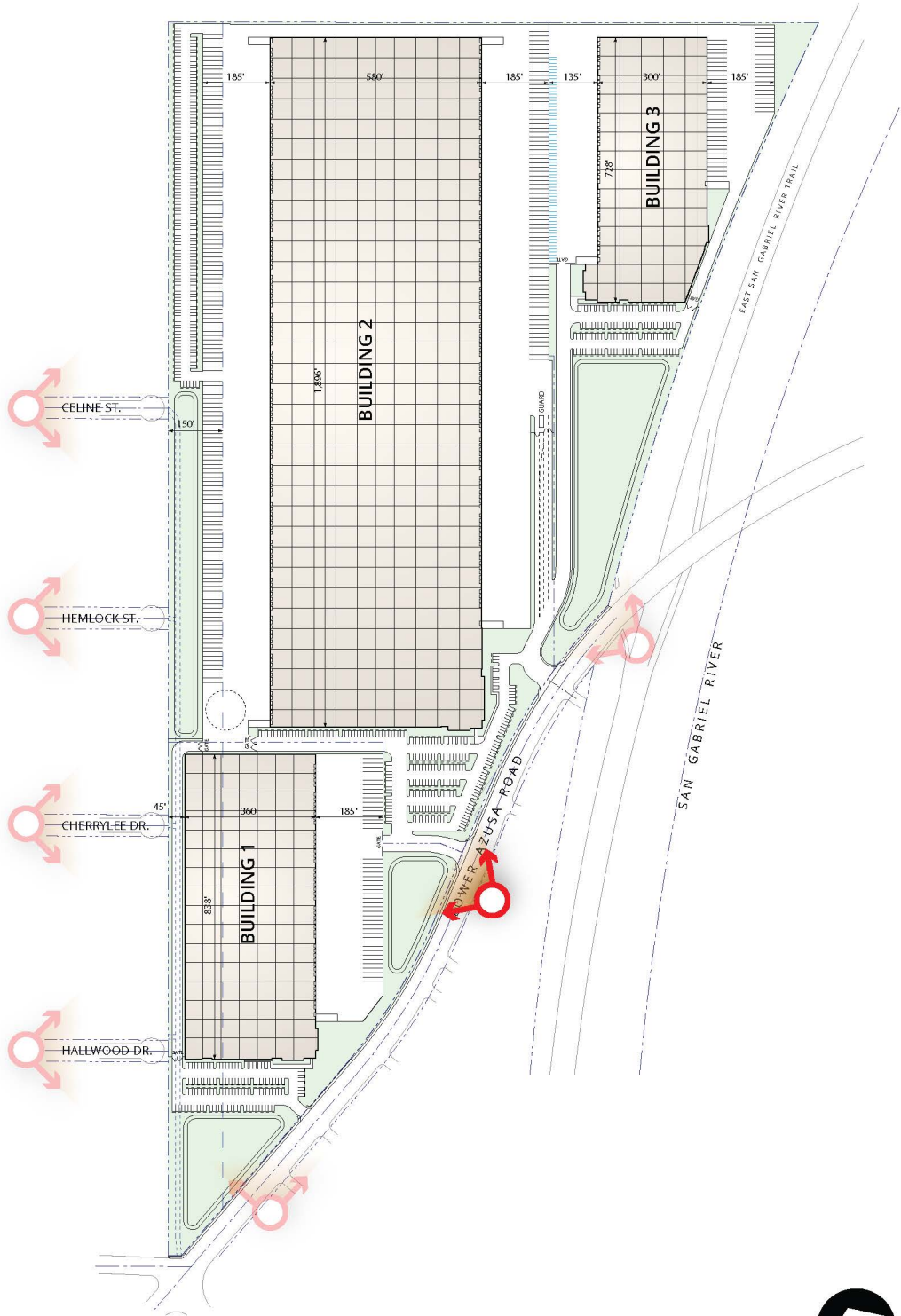

ARCADIA LOGISTICS CENTER,
CITY OF ARCADIA, CALIFORNIA

LOWER AZUSA ROAD. VIEW 3, looking East towards Building 2. The view was taken at approximately 3:30 PM, using a 38 mm lens, approximately 500 feet from Building 2. The maximum visible building height is 42 feet with a foreground buffer of proposed and existing trees.

